

“TiBi” PENDANT INSTALLATION INSTRUCTIONS

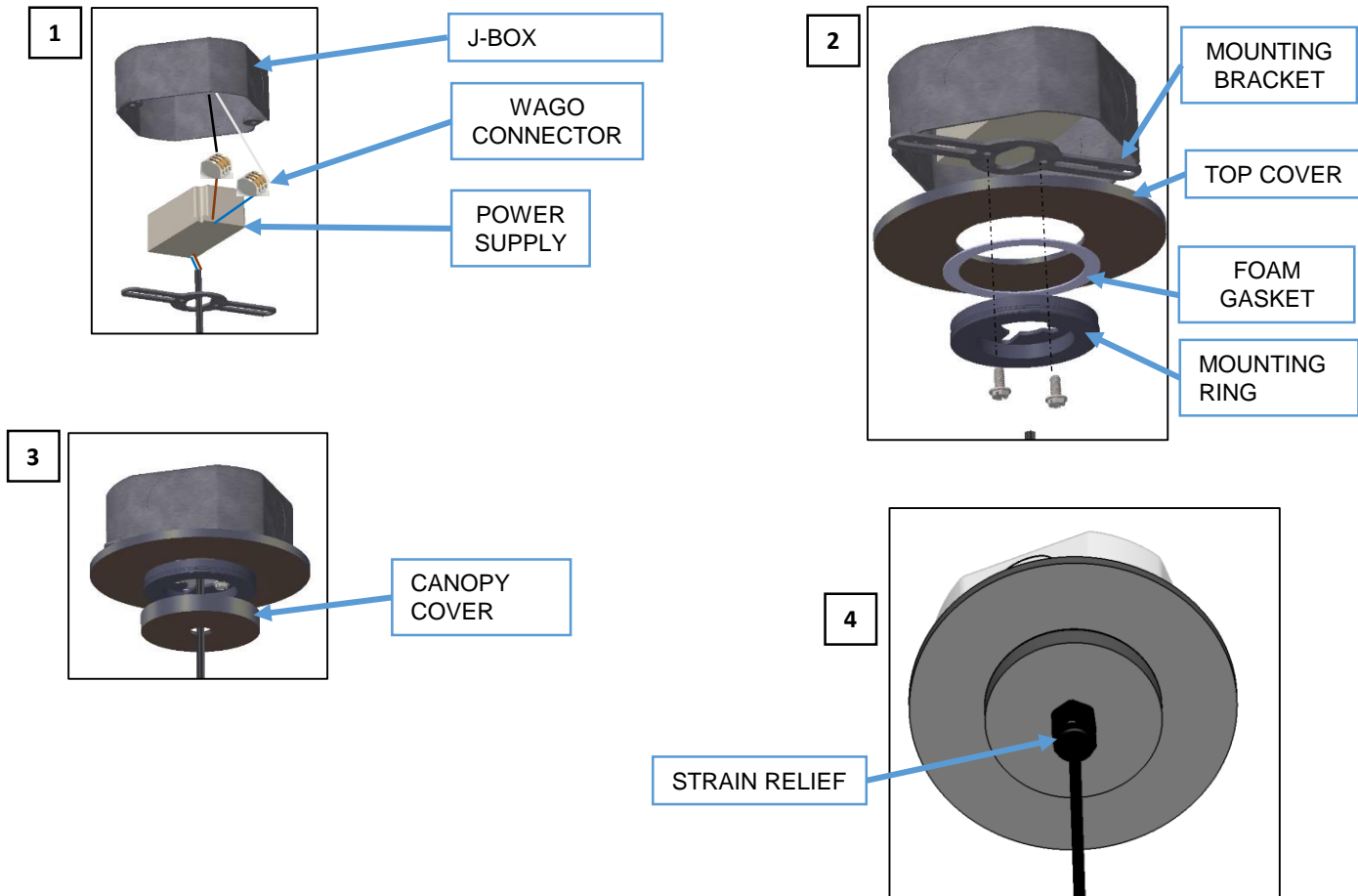

WARNING - RISK OF FIRE AND ELECTRICAL SHOCK. FIXTURE MUST BE INSTALLED BY A QUALIFIED ELECTRICIAN ONLY. FIXTURE IS INTENDED FOR INSTALLATION IN ACCORDANCE WITH THE NATIONAL ELECTRICAL CODE, LOCAL AND FEDERAL SPECIFICATIONS. DISCONNECT POWER AT ELECTRICAL PANEL BEFORE SERVICING.
RETAIN THESE INSTRUCTIONS FOR MAINTENANCE REFERENCE.

FIXTURE INSTALLATION



1. ADJUST THE CORD LENGTH ,LOOSE THE STRAIN RELIEF ON THE COVER AND MOVE IT ALONG THE POWER CORD TO THE DESIRED HEIGHT. CUT AND STRIP THE CABLE TO REVEAL 2 WIRES, STRIP THE 2 WIRES AND CONNECT TO THE MAIN LINE TO POWER SUPPLY USING THE WAGO CONNECTORS ALREADY ON THE FIXTURE, BROWN TO BLACK AND BLUE TO WHITE. (FIGURE 1)
2. INSTALL THE MOUNTING BRACKETED (GALVANIZED STEEL) WITH 2 SCREWS ON THE J-BOX (FIGURE 2)
3. INSTALL IN ORDER TOP COVER ,FOAM GASKET AND FIX THE MOUNTING RING WITH 2 SCREWS 8-32 UNC. (FIGURE 2)
4. ATTACH CANOPY COVER TO MOUNTING RING THREAING IT (FIGURE 3) THREAD THE STRAIN RELIEF ON THE CANOPY COVER (FIGURE 4)
5. TURN ON POWER TO LIGHT FIXTURE.